

DYNATROL I-XL OR DYNATRED  
JOINT SEALANT - MAINTAIN 2:1  
SEALANT WIDTH TO DEPTH RATIO

CLOSED CELL BACKER ROD

JOINT FILLER OR SAFING  
INSULATION (OPTIONAL)

806 FC TOP/804 FC INTERMEDIATE  
COATS OR 806 FC TOP COAT(S)

802 FC BASE COAT

P-801-VOC PRIMER

CONCRETE DECK

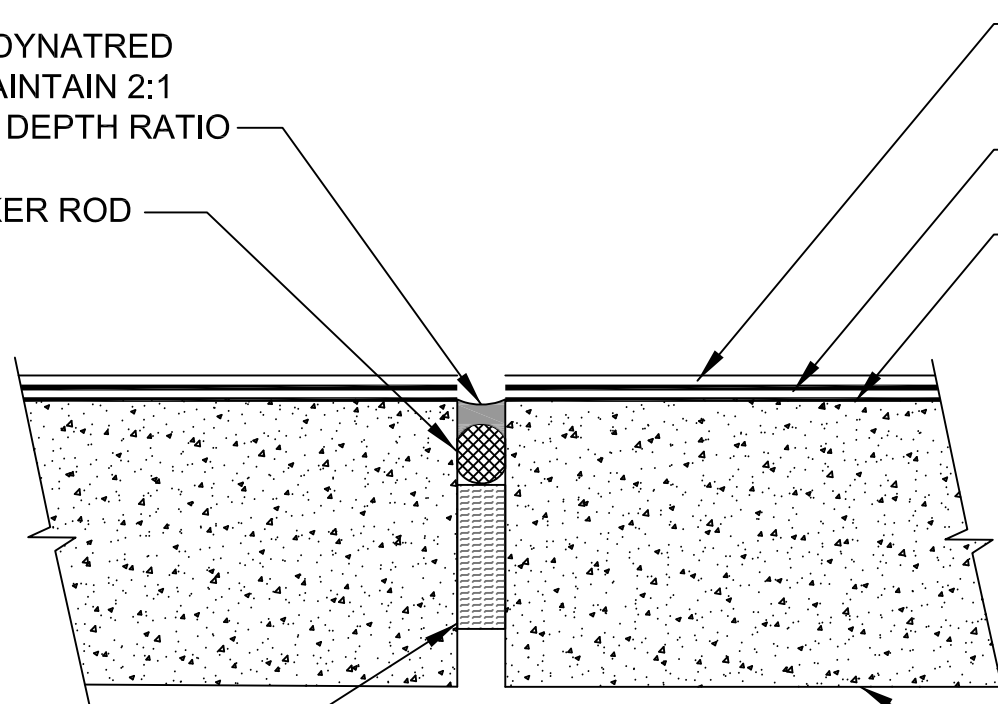

**PECORA  
CORPORATION®**

Architectural Weatherproofing Products  
U.S.A. • since 1862

Pecora Corporation is a manufacturer of materials and not a licensed design professional. Details prepared by Pecora are schematic only and are offered as a guide for the convenience of Pecora's customers.

07 18 00 - TRAFFIC COATINGS / B3040 - TRAFFIC BEARING COATINGS  
**PECORA-DECK 800 FC DECK COATING SYSTEM**  
EXPANSION JOINTS GREATER THAN 1/2" IN WIDTH

NO SCALE

REV. 10-2016

DWG NO.: PEC-DT-800FC-105