

CLOSED CELL BACKER ROD &
 PECORA DECK-SEAL or DYNATRED
 TRAFFIC-GRADE POLYURETHANE
 JOINT SEALANT - MAINTAIN 2:1
 SEALANT WIDTH TO DEPTH
 RATIO

SUPPLEMENTARY
 JOINT FILLER or SAFING
 (OPTIONAL)

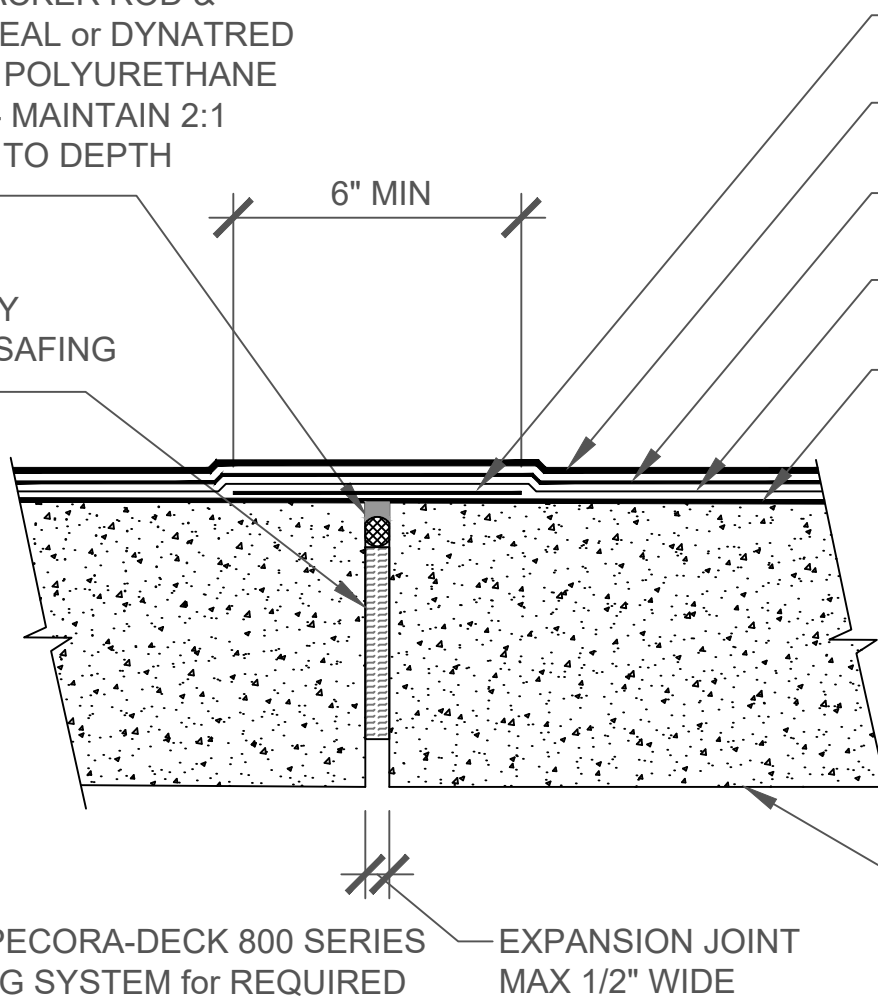

DEATIL COAT of PECORA-DECK 802 BASE COAT
 PECORA-DECK 806 TOP COAT
 PECORA-DECK 806 INTERMEDIATE COAT
 PECORA-DECK 802 BASE COAT
 PECORA P-801-VOC POLYURETHANE or
 P-808 EPOXY PRIMER

CAST-IN-PLACE or PRECAST CONCRETE
 FLOOR, DECK, or SLAB

NOTE:
 SEE SPECIFIED PECORA-DECK 800 SERIES
 TRAFFIC COATING SYSTEM for REQUIRED
 COATINGS, COATING THICKNESSES &
 AGGREGATE SIZES.

EXPANSION JOINT
 MAX 1/2" WIDE



Pecora Corporation is a manufacturer of materials and not a licensed design professional. Details prepared by Pecora are schematic only and are offered as a guide for the convenience of Pecora's customers.

07 18 00 - TRAFFIC COATINGS / B3040 - TRAFFIC BEARING COATINGS
PECORA-DECK 800 SERIES DECK COATING SYSTEM
EXPANSION JOINTS UP TO 1/2" IN WIDTH

NO SCALE

REV: 3-2021

DWG NO: PEC-800-104