

CLOSED CELL BACKER ROD &  
 PECORA DECK-SEAL or DYNATRED  
 TRAFFIC-GRADE POLYURETHANE  
 JOINT SEALANT - MAINTAIN 2:1  
 SEALANT WIDTH TO DEPTH  
 RATIO

SUPPLEMENTARY  
 JOINT FILLER or SAFING  
 (OPTIONAL)

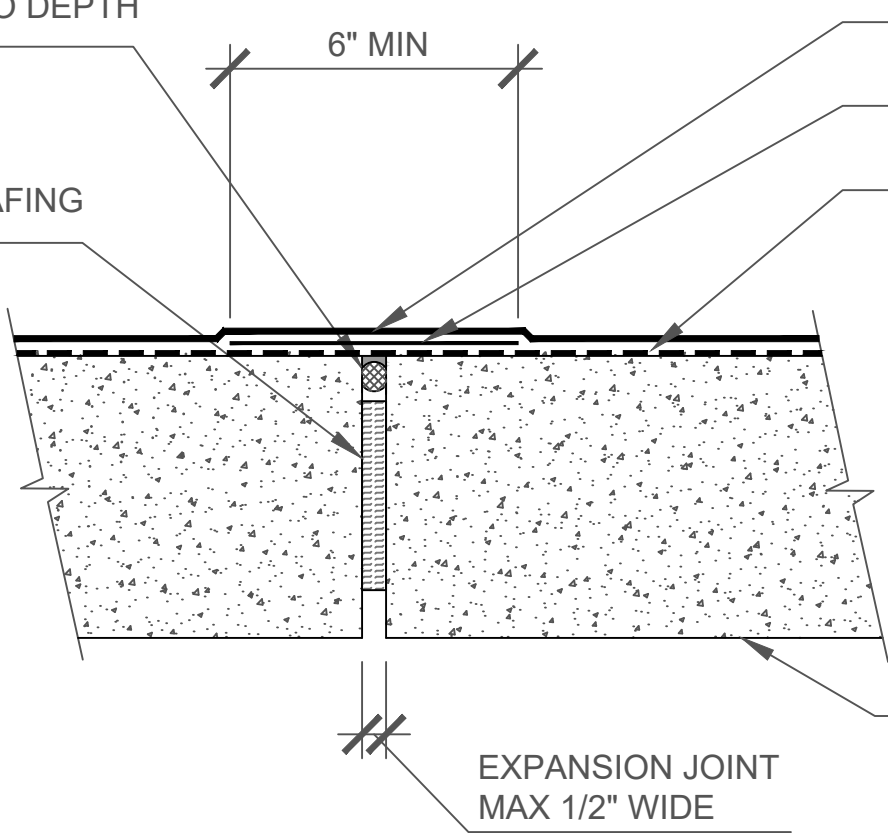

PECORA-DECK HB1100-SA TOP COAT

DETAIL COAT of PECORA-DECK HB1100-SA

PECORA P-801-VOC POLYURETHANE PRIMER  
 or P-808 EPOXY PRIMER (PRIMER OPTIONAL  
 for PEDESTRIAN-GRADE COATING ONLY)

CAST-IN-PLACE or PRECAST CONCRETE  
 FLOOR, DECK, or SLAB

EXPANSION JOINT  
 MAX 1/2" WIDE

NOTE:  
 SEE HB1100-SA APPLICATION & TRAINING MANUAL for COATING  
 SYSTEM THICKNESSES & FULL INSTALLATION INSTRUCTIONS.



**PECORA  
 CORPORATION**

Architectural Weatherproofing Products  
 U.S.A. • since 1862

Pecora Corporation is a  
 manufacturer of materials  
 and not a licensed design  
 professional. Details  
 prepared by Pecora are  
 schematic only and are  
 offered as a guide for the  
 convenience of Pecora's  
 customers.

07 18 00 - TRAFFIC COATINGS / B3040 - TRAFFIC BEARING COATINGS  
**PECORA-DECK HB1100-SA ONE-STEP TRAFFIC COATING**  
**EXPANSION JOINTS UP TO 1/2" IN WIDTH**

NO SCALE

REV: 02/2024

DWG NO: PEC-HB1100SA-104